

Prior to the scheduled window replacement date for each room on all floor levels clear all items within the red shaded area, approximately 4 feet back from the exterior wall to allow for the installation of the construction hoarding.

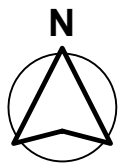

1/16" = 1'-0"

2020/11/30

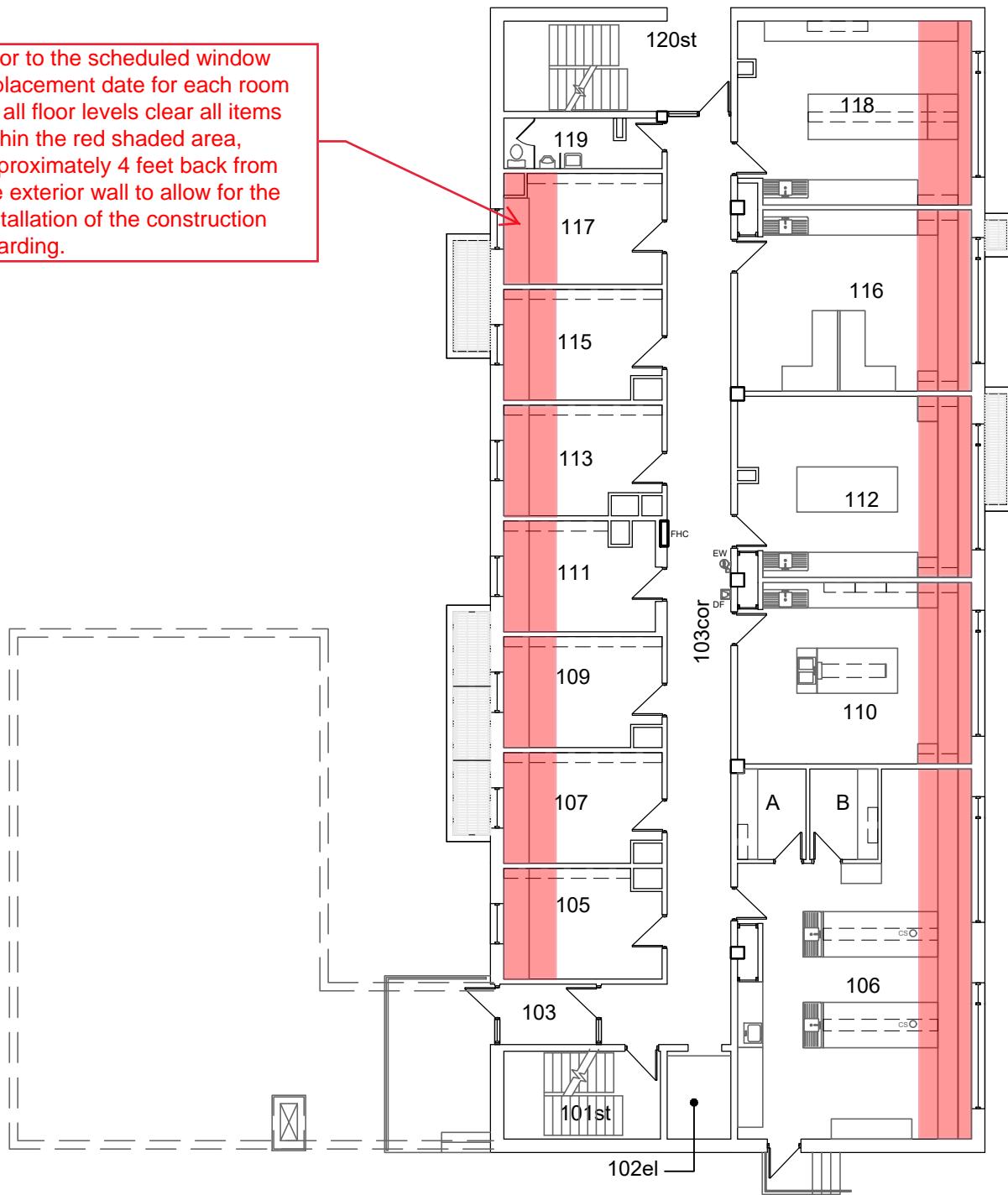

University of Manitoba

Physical Plant Department
Architectural and Engineering Services

PLANT SCIENCES BUILDING - 025
7 SERVICE STREET 3S, WINNIPEG MB
LEVEL 100